

General Supplies



Ortho Bonding

Embrace™ Light Cure

Embrace™ Cure on Touch

Lute + GIC

Versa Hook

Begg's Supplies

Auxillaries

Photographic Accessories

Typodonts

Practice Builders



Embrace™ Light cure

Features

- Unlimited working time to place steel, and plastic ceramic brackets.
- Cures in only 20 seconds of light exposure.
- Small particle filler for extra strength but easy to debond.
- Color stable to preserve excellent aesthetics.
- Shelf life of at least 2 years at room temperature
- Pack:- 5gms paste, 3gms primer, 3gms etch.



Embrace™ Cure on touch

Features

- No-mix bonding system to fix metal, ceramic and plastic brackets on enamel.
- Consists of a liquid primer and a pasty adhesive.
- Both components cure upon contact quickly & permanently.
- Remarkable bonding strength, yet easy to debond.
- Pack:- 5gms paste, 5gms primer, 3gms etch.



Etching Gel

Features

- Silica Free, High quality, non-drying, medium viscosity gel.
- Thixotropic, stays put, does not run
- Visible blue colour, Visible bubbling action on tooth
- Washes off quickly and easily due to excellent water solubility



**Also available in 10 ml dropper bottle pack*

Lute + Band Fixing GIC

Features

- Premium quality cement for luting.
- Forms a thin continuous film.
- Average particle size < 2 micron.
- Highly radio opaque



Versa™ Hook

Features

- Universal Hook : You don't need to keep many kinds of hooks in stock.
- Multi direction : You can decide the direction of hook by yourself.
- Length adjustable: You can adjust a length of hook with a cutter (max 16mm)
- Functions as a posted wire : You can use the hook instead of posted wire
- Packing unit : 10 pcs (10 bases + 10 hooks)

“Conventional crimpable hooks have a fixed height which may be too less or too much for your exact force application. Versa-hook allows the orthodontic professional to select the height of the hook & thereby provides the exact height that is needed for the direction of force. The hook is also Bidirectional (can be used as left or right)”



NOTE: Versa hook works best with our special “Versa Hook plier”

1. Cut with a cutter to desired length.

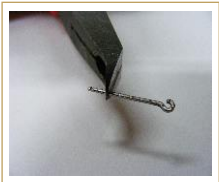

2. Assembly with two parts



3. Crimp the base and hook with Versa plier as shown



4. Hold in Versa plier



5. Fix the hook on proper position



Protraction face mask

Features

- Fully adjustable forehead and chin rests allow for adaptation to most patient's anatomical structure.
- Light weight stainless steel and plastic construction.
- Padded supports. Extra set of pads enclosed in the pack.



Headgear with safety release

Extra heavy duty construction for sturdy dependability. Easy to adjust.



High pull head cap

(Small, Medium, Large)

Three sizes of head caps, each with two placement loops, ensures accurate fit for patients.



Neck pad

These soft and comfortable neck pads are made of 100% cotton for breathable comfort. Available in a variety of colors.



Safety release modules

Release action prevents slingshot effect. When the bow is pulled from the front the device will release safely without injury to the patient.



Begg's Bracket Curved

Begg's Bracket Curved for cuspids & bicuspids. High quality mesh base.

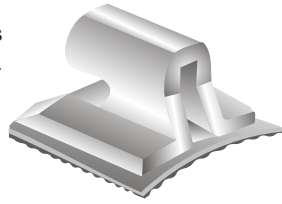

Begg's Bracket Flat

Flat Begg's bracket for centrals & laterals. High quality mesh base.

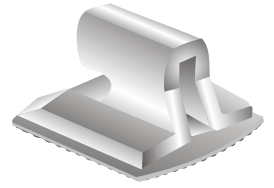

Begg's Tube Bondable

High quality mesh base for maximum retention.

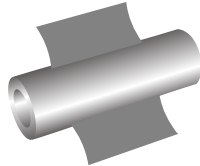

Begg's Tube Weldable

Precision engineered. Top quality.

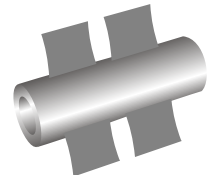

Lock Pins Stage I,II & III

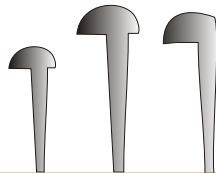

Ligature Wire

Our ligature wire is available in bulk 500gm spool. 100gm & 50gm spool are also available.



Expansion Screw

Precision engineered with the finest stainless steel. Gives excellent results. One key is supplied. With every screw.



Interproximal Strip

Removes interproximal tooth mass to produce additional intra-arch space. May also be used for opening contact points, recontouring or removing overhanging fillings.



Rotation Wedges

(Standard)

A preformed tab is perforated to lock in place on one set of tie wings of a twin bracket. The wedge portion allows the necessary fulcrum between wire & bracket for efficient rotation.



Contouring Kit

Quickly and safely gives you the precise interproximal space you need. Kit includes one hand instrument plus 10 interchangeable blades.



Facebow

Features

- Sturdy construction
- Plain inner bow allows you the flexibility to make your bends or loops
- Outer 0.072 & inner 0.045

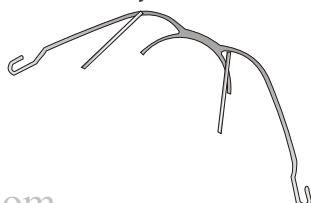

Palatal Bar

34mm, 37mm, 41mm, 45mm, 47mm



Reverse loop palatal bar

34mm, 37mm, 41mm, 45mm, 47mm

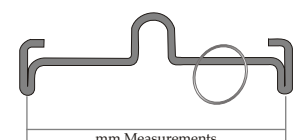

Bondable Button

Metal injection Molded and designed to conform to tooth Surface. Mesh base for maximum retention.



Bondable Cleat

Low-profile design with smooth hooks. Easily adjusted for elastic placement or other treatment purposes.



Weldable Button

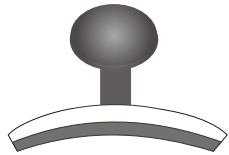

Weldable Cleat

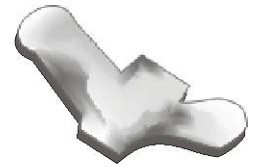

Lingual Sheath (Optional with hook)

Precision engineered. Available with or without hook.

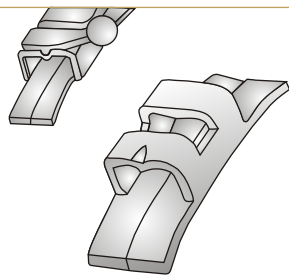

Direct Bond Lingual Sheath

With mesh pad, bonds directly to molars. .036 slotted, horizontal, latching indent. Fits left or right.



Crimpable Hook Short

Sturdy ball hooks, remain firmly in place when crimped.

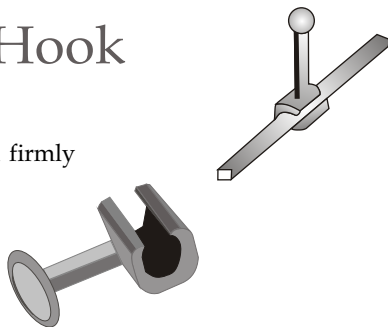

Crimpable Hook Long

Sturdy ball hooks, remain firmly in place when crimped.

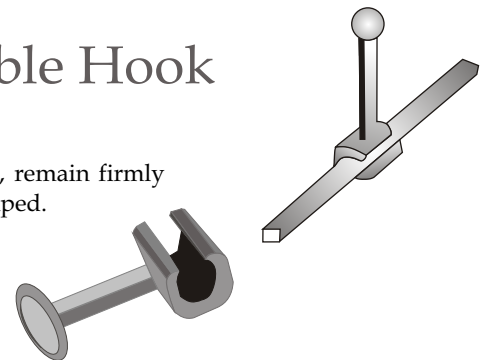

Crimpable Hook Curved Left & Right

Curved Left & Right

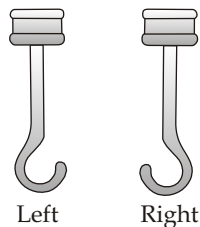

Lingual Cleat Wide & Narrow

Wide & Narrow

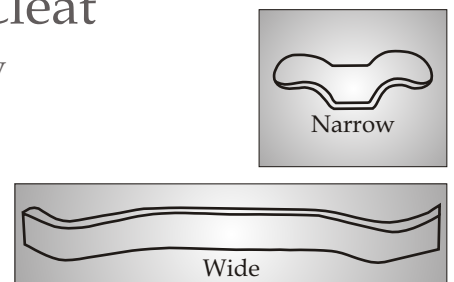

Bondable Retainer

Upper 2-2

Direct bonding, suitable thickness and hardness, easy to use.

*Small: 14mm •Medium: 16mm •Large: 18mm

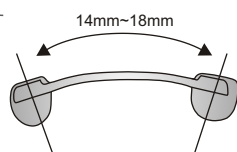

Lower 3-3

Direct bonding, suitable thickness and hardness, easy to use.

*Sizes: 30mm ,31mm, 32mm, 33mm, 34mm.

*Sizes: 35mm ,36mm, 37mm, 38mm, 39mm.

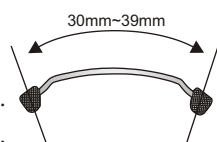

Bondable Retainer (3-3)

Direct bonding, suitable thickness and hardness, easy to use.

*Sizes: 38mm ,40mm, 42mm, 44mm, 46mm.

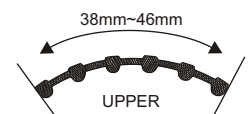

*Sizes: 29mm ,31mm, 33mm, 35mm, 37mm.

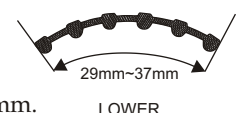

Tuff Lock Trays

A unique mechanical locking system eliminates the need for spray adhesive. A clean, complete impression is assured. High sides provides excellent margin and gingival detail. Available in five color-coded sizes, for both upper and lower arches.

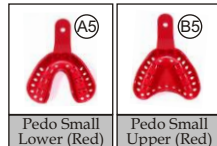
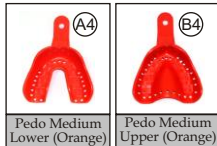
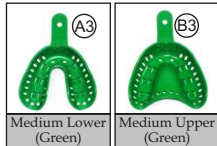
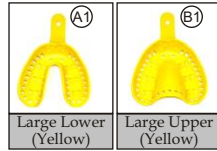
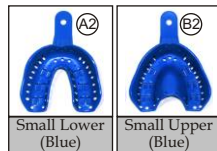

Patient Relief Wax

For patient's emergency use when appliance is irritating soft tissue. Easily applied providing immediate temporary relief. Choose form regular or scented cases or mint flavored.



Digital Vernier

Specifically designed for precise dental measurements, this digital vernier makes data collection fast and accurate in inches and millimeters.



Mirror In Plastic Handle

High quality ...very economical



Alginate Bowl & Spatula

Super flexible bowl in a variety of colors. Pliable material helps in mixing alginate more efficiently. Plastic spatulas designed to complement our bowls. Easy grip handle .



Ortho Pliers Stand

Anodized aluminum light weight construction. Pliers fit perfectly. Ergonomic design.

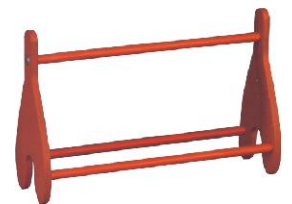

Wire Organizer & Dispenser



Can hold 18 different archwires. Helps in easy location of desired wire & also helps in keeping a regular check on inventory. Sleek & modern looking.



Spool Dispenser

Keep your spooled products organized. Easy to use dispenser for chain elastic, tissue guard, thread, coil springs, etc

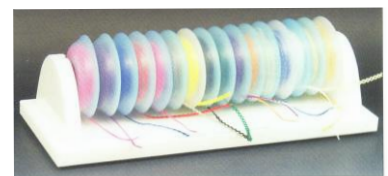

Photographic Mirrors

High resolution intraoral photos depend on superior reflective mirrors. Rhodium on glass provides the clearest, brightest and most accurate reflection of any mirror material.



Photo Cheek Retractors

Made of crystal clear plastic for photographic purpose. Compatible with cold sterilization or autoclaving (<120°C). Can be autoclaved.



Cheek Retractor Superflex

Superflexible construction. Will not break even after repeated retractions.



Cheek Retractor With Tongue Block

Clever design blocks tongue while retracting & prevents saliva contamination of working area.

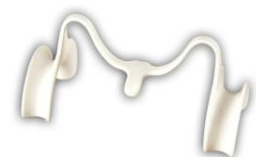

Typodonts

Acrylic-type life size model.
Clear, flat hinge can be removed.
suitable for patients, staff,
and educational purposes.
Brackets can be attached with gel
type super glue.

Class One



Class Two



Class Two 1st



Class Two 3rd



Class Three



With Metal Bracket



Practice builders

Brush Holder
with brushing time
3 mins sandclock



Brush Holder
with Vacuum
pad Base



Magnetic Clip
Stays on Metal Cabinets, Refrigerators
Magnetic write and wipe board



Wall Clock



For your clinic
reception.

Retainer Boxes



Very handy for small appliances
like retainers. High quality
molding gives a aesthetic & sleek
product.

Wind Up Chomping
Teeth



Wind them up, put them down,
watch them chomp as they
walk. Then see your patients
smile.

Keychain

